



SWISS MILITARY

HANOWA

5030.D

INSTRUCTION MANUAL | BEDIENUNGSANLEITUNG | MANUEL D'INSTRUCTIONS
INSTRUCCIONES DE USO | ISTRUZIONI PER L'USO

操作指南 取扱説明書 사용 설명서 ИНСТРУКЦИЯ ПО ЭКСПЛУАТАЦИИ دليل التعليمات

CHRONO & DATE

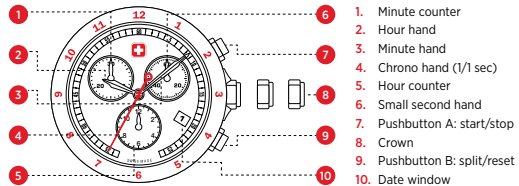

SET THE TIME

SET

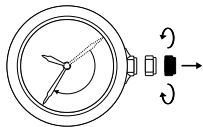

RESET

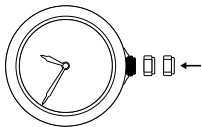

SETTING THE DATE

SET

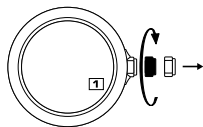

RESET

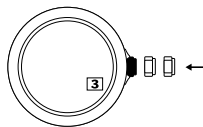

During the date changing phase between 9:00PM and 12PM; the date must be set to the date of the following day.

MEASURING THE CUMULATIVE TIME

START

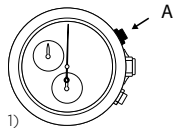

STOP

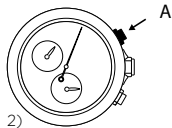

Step 1 and 2 can be repeated several times in a row

RESET

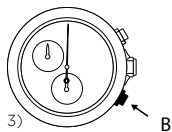

MEASURING THE SPLIT TIMES

START

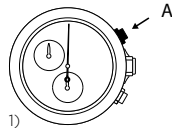

SPLIT

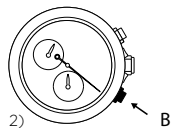

FOLLOW-UP

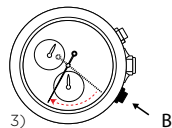

Step 2 and 3 can be repeated several times in a row

STOP

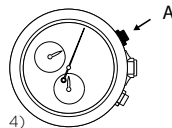

RESET

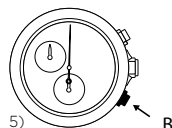

REINITIALIZING OF CHRONO- AND COUNTER HANDS

Following a battery change, an incorrect actuation, violent impact or exposure to a strong magnetic field, the chrono hand, and/or the counter hands may fail to revert to their original position (0).

To calibrate chrono- and counter hands, proceed as follows:

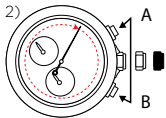
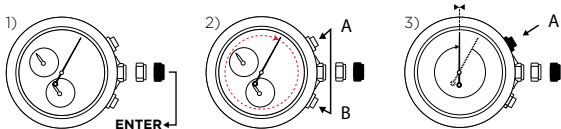

min. 2 seconds

The chrono hand rotates by 360°
--> corrective mode is activated.

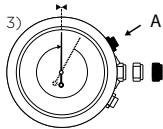

Reset the chrono hand

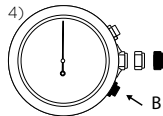

Confirm/Next

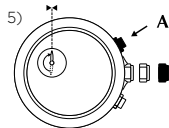

Reset minute counter

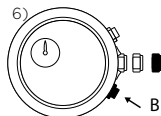

Confirm/Next

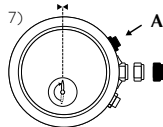

Reset hour counter

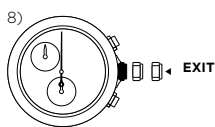

EXIT

Caution: Make always sure that the crown is in the pushed-in position in order to ensure the water resistance of the watch. Pushbuttons A/B and crown should never be operated under water.



Battery type:
395 - SR57

CHRONO & DATUM

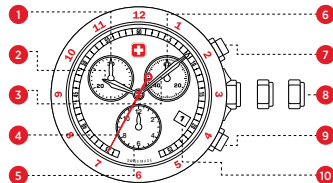

1. Minutenzähler
2. Stundenzeiger
3. Minutenzeiger
4. Chronozeiger (1/1 sec)
5. Stundenzähler
6. kleiner Sekundenzeiger
7. Drücker A: start/stop
8. Krone
9. Drücker B: Zwischenzeit/reset
10. Datumsfenster

EINSTELLEN DER ZEIT

SET

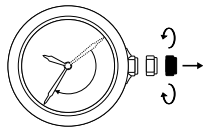

RESET

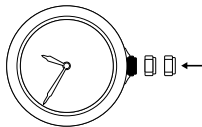

EINSTELLEN DES DATUMS

SET

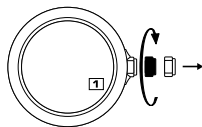

RESET

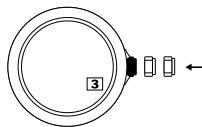

In der Kalenderschaltphase zwischen 21:00 und 24:00 Uhr muss das Datum des folgenden Tages eingestellt werden.

MESSUNG DER KUMULIERTEN ZEIT

START

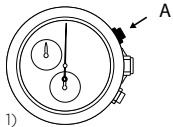

STOPPEN

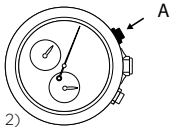

ZURÜCKSETZEN

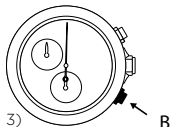

Schritt 1 und 2 können während einer Zeitmessung beliebig oft wiederholt werden.

MESSUNG DER ZWISCHENZEITEN

START

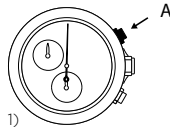

ZWISCHENZEIT

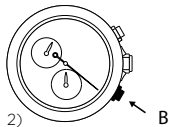

FORTSETZEN

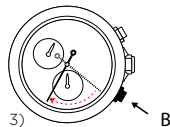

STOPPEN

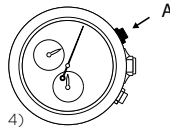

ZURÜCKSETZEN

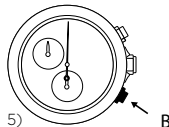

Schritt 2 und 3 können während einer Zeitmessung beliebig oft wiederholt werden.

KALIBRIERUNG DES CHRONOZEIGERS UND DER ZÄHLER

Nach Batteriewechsel, einer falschen Betätigung, starkem Aufprall oder nach dem Einwirken starker magnetischer Felder, kann es vorkommen, dass der Chronozeiger und/oder die Zähler nicht automatisch auf ihre Ursprungspositionen (0) zurückgehen.

Um die Zeiger zurückzusetzen, gehen Sie wie folgt vor:

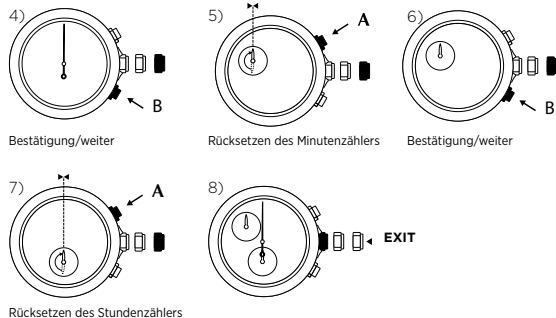
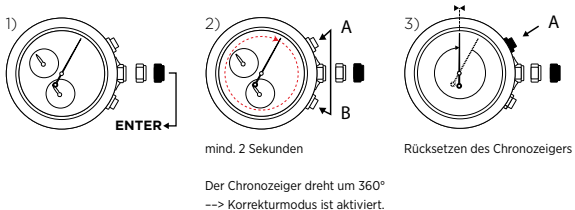

Vorsicht: Vergewissern Sie sich immer, dass die Krone eingedrückt ist, damit die Wasserdichtigkeit der Uhr gewährleistet ist. Drücker A/B sowie Krone sollten unter Wasser nie betätigt werden.



Batterietyp:
395 - SR57

CHRONO & DATE

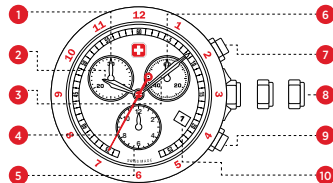

1. Compteur des minutes
2. Aiguille des heures
3. Aiguille des minutes
4. Aiguille chrono (1/1 sec)
5. Compteur des heures
6. Petite aiguille des secondes
7. Poussoir A: start/stop
8. Couronne
9. Poussoir B: intermédiaire/reset
10. Indicateur de la date

RÉGLAGE DE L'HEURE ET DES MINUTES

SET

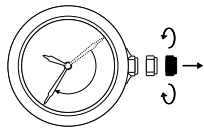

RESET

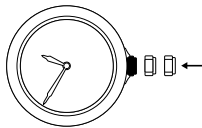

RÉGLAGE DE LA DATE

SET

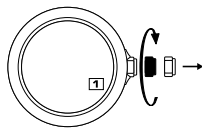

RESET

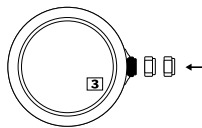

Pendant la phase d'entraînement du calendrier entre 21h00 et 0h00, il faut mettre en place la date du jour suivant.

MESURE DE TEMPS CUMULÉS

START

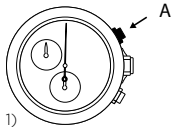

STOP

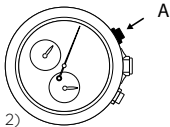

RESET

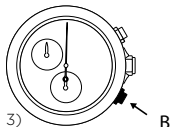

Pas 1 et 2 peuvent être répétés plusieurs fois consécutif

MESURE DE TEMPS INTERMÉDIAIRES

START

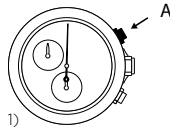

INTERMÉD.

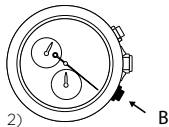

RATTRAPAGE

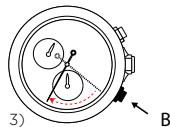

STOP

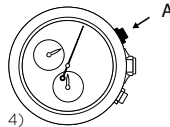

RESET

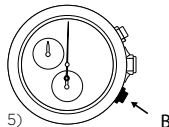

Pas 2 et 3 peuvent être répétés plusieurs fois consécutif

INITIALISATION DE L'AIGUILLE CHRONO ET DES AIGUILLES COMPTEURS

À la suite d'un changement de pile, d'une mise à jour incorrecte, d'un choc violent ou de l'exposition à un fort champ magnétique, il peut arriver que l'aiguille chrono et/ou les aiguilles des compteurs ne reviennent pas correctement à leur position initiale (0). Pour calibrer ces aiguilles, procédez de la manière suivante:

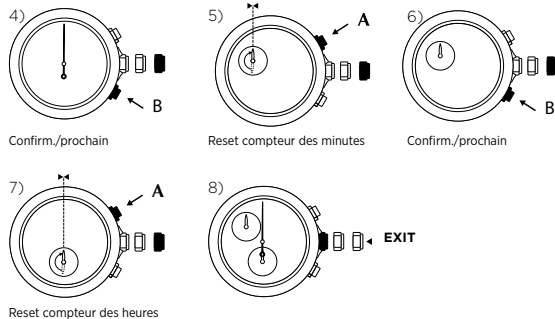
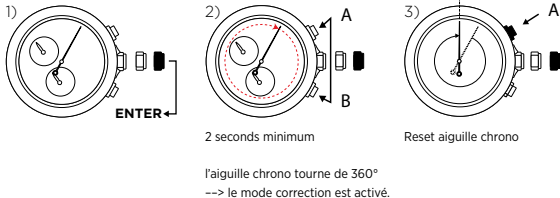

Attention: Rassurez-vous, que la couronne soit toujours dans la position fermée, pour éviter l'entrée d'eau ou de l'humidité. Les poussoirs A/B ainsi que la couronne ne doivent pas être utilisés sous l'eau.



Pile type:
395 - SR57

CHRONO & TFECHA

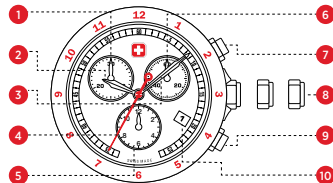

1. Contador de minutos
2. Aguja de horas
3. Aguja de minutos
4. Aguja crono (1/1 segundo)
5. Contador de minutos
6. Aguja de segundos pequeña
7. Pulsador A: inicio/parada
8. Corona
9. Pulsador B: intermedio/reinicio
10. Ventanilla de fecha

AJUSTE HORA Y MINUTO

SET

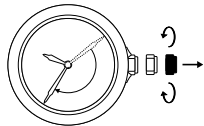

RESET

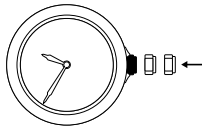

AJUSTE DE LA FECHA

SET

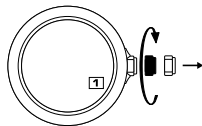

RESET

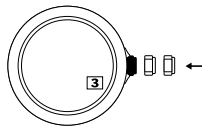

Durante la fase de cambio de calendario entre las horas 21:00 y 24:00; se pone la fecha de el próximo día.

MEDIDAS DE TIEMPOS ACUMULADOS

INICIO

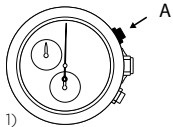

PARADA

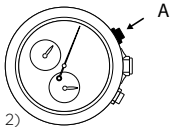

REINICIO

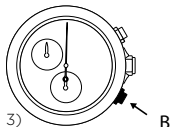

I passi 1 e 2 possono essere ripetuti varie volte consecutivamente

MEDIDA DE TIEMPOS INTERMEDIOS

START

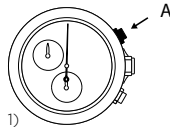

INTERMEDIO

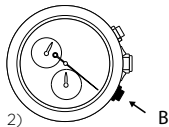

REANUDAR

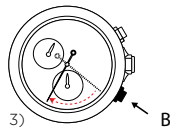

PARADA

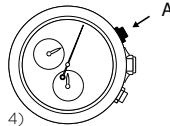

REINICIO

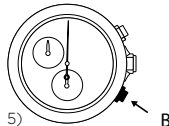

I passi 2 e 3 possono essere ripetuti varie volte consecutivamente

REAJUSTE DE LAS MANECILLAS DEL CRONÓGRAFO

Tras un cambio de pila, un uso incorrecto; impacto violento o exposición a campos magnéticos, las manecillas del cronógrafo pueden desajustarse de su posición inicial (0).
Para ajustarlas, proceda como sigue:

Para ajustarlas, proceda como sigue:

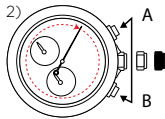
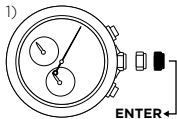

min. 2 segundos

La manecilla del crono gira 360°
--> función de ajuste manual activada.

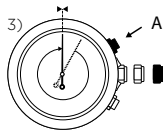

Reposición aguja crono

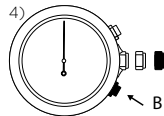

Confirma/Próximo

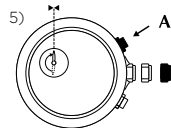

Reposición contador de minutos

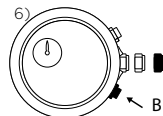

Confirma/Próximo

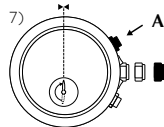

Reposición contador de horas

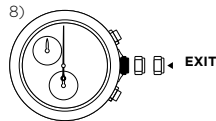

Precaución: Asegúrese siempre de que la corona está presionada en su posición inicial para asegurar su sumergibilidad. No deberá nunca presionar los botones A/B bajo el agua, esto podría dañar la maquinaria.



Clase de batería:
395 - SR57

CHRONO & DATA

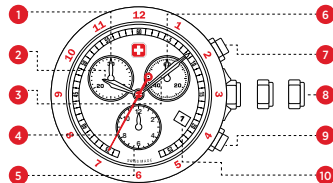

1. Contatore dei minuti
2. Lancetta delle ore
3. Lancetta dei minuti
4. Lancetta crono (1/1 secondo)
5. Contatore delle ore
6. Piccola lancetta dei secondi
7. Pulsante A: start/stop
8. Corona
9. Pulsante B: intermedio/reset
10. Casella del datario

CORREZIONE DELL'ORARIO

SET

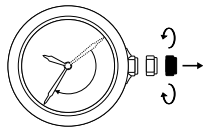

RESET

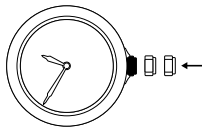

CORREZIONE DELLA DATA

SET

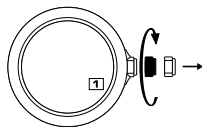

RESET

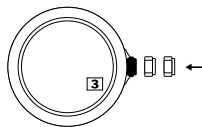

Durante la fase del cambio calendario, fra le ore 21.00 e le ore 24.00, deve essere imposta la data del giorno seguente.

MISURAZIONE DEI TEMPI CUMULATI

START

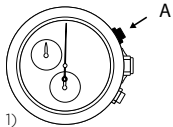

STOP

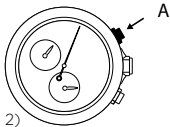

AZZERA

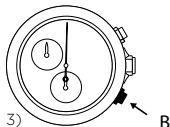

MISURAZIONE DEI TEMPI INTERMEDI

START

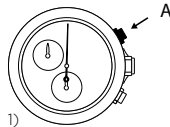

INTERMED.

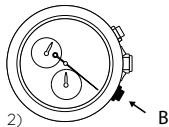

RIANNODA

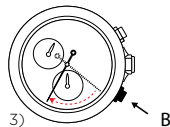

STOP

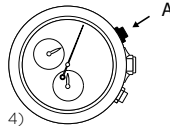

AZZERA

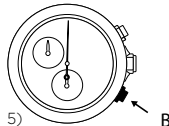

La función de tiempos intermedios o acumulados se puede repetir varias veces durante un cronometraje.

RE-INIZIALIZAZIONE DELLE LANCETTE CRONO E CONTATORI DELLE ORE E DEI MINUTI

Dopo il cambio di pila, utilizzo incorretto, impatti violenti oppure esposizione a dei forti campi magnetici, può capitare che la lancette crono o/e le lancette dei due contatori non tornino alle loro posizioni iniziali (zero). Per calibrare queste lancette procedete nel modo seguente:

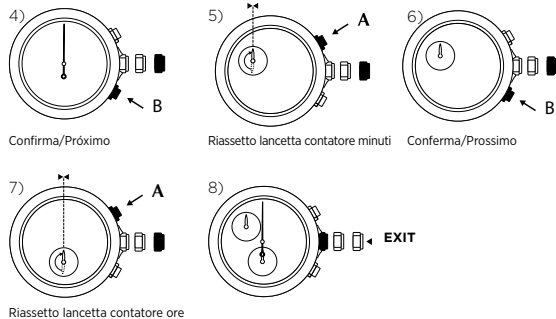

Avviso: Assicuratevi che la corona sia sempre in posizione chiusa in modo da evitare l'ingresso d'acqua o d'umidità. I pulsanti A/B cosicché la corona non devono essere utilizzati in acqua.



Tipo Pila:
395 - SR57

计时/日期

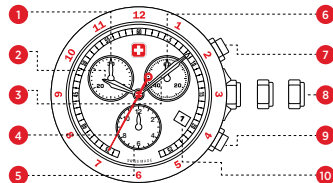

1. 分钟计时器
2. 时针
3. 分针
4. 计时指针 (1/10秒)
5. 小时计时器
6. 小秒针
7. 按钮A: 开始/停止
8. 表冠
9. 按钮B: 暂停/重置
10. 日期显示窗

设定时间

设定

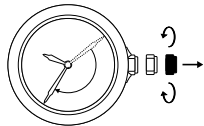

重置

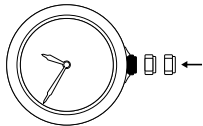

设定日期

设定

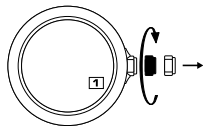

重置

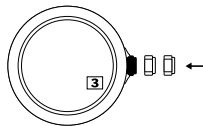

在晚上9点和晚上12点之间的日期变更过程中; 必须将日期设定为第二天。

测定累积时间

开始

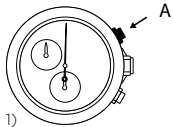

停止

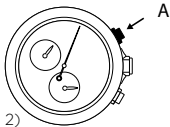

重置

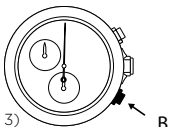

步骤1和2可以连续重复几次

测定分段时间

开始

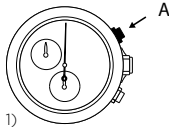

暂停

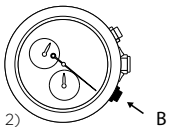

重启

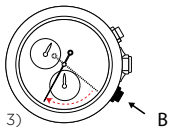

停止

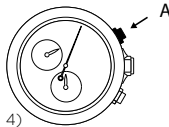

重置

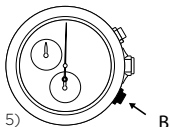

步骤2和3可以连续重复几次

重新初始化计时器 - 和计数器指针

更换电池、不当启动、猛烈冲击或暴露在强磁场中后，自动计时器指针和/或计数器指针可能无法回复到其初始位置。

按以下步骤校准指针：

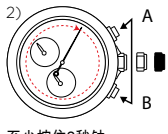
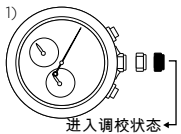

至少按住2秒钟

计时器指针旋转360°
—> 纠正模式被激活。

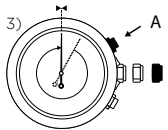

重置计时指针

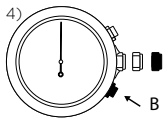

确定/下一个

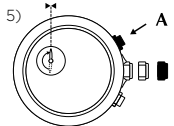

重置分钟计时器

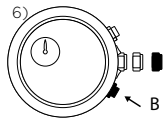

确定/下一个

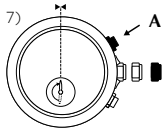

重置分钟计时器

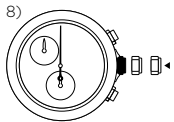

退出

警告 确保表冠一直处于推入的位置，以保证手表的防水性。绝不可以在水下操作按钮A/B和表冠



电池类型

395 - SR57

クロノ/日

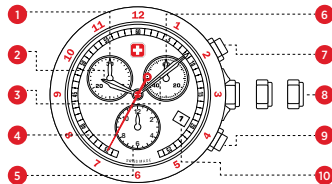

1. 分カウンタ
2. 短針
3. 長針
4. 秒針 (1/1 秒)
5. 時カウンター
6. 秒針 (小)
7. 押しボタンA: スタート/ストップ
8. リューズ
9. 押しボタンB: スプリット/リセット
10. 日付表示

時刻の設定

セット

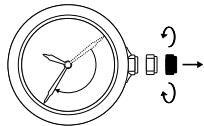

リセット

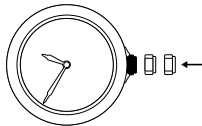

日付の設定

セット

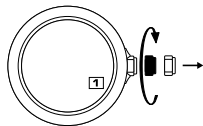

リセット

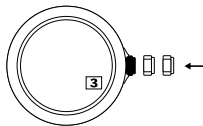

午後9時から12時の間に日付を変更する場合は、必ず翌日の日付を設定してください。

累積時間の計測

スタート

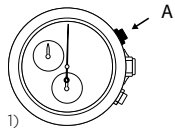

ストップ

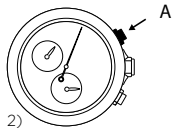

リセット

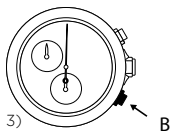

ステップ 1 と 2 を連続して数回繰り返すことができます

スプリットタイムの計測

スタート

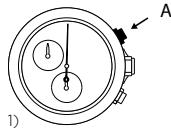

スプリット

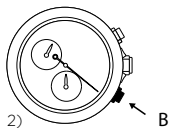

リスタート

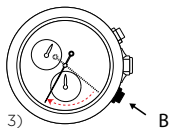

ストップ

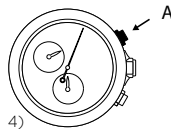

リセット

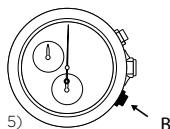

ステップ 2 と 3 を連続して数回繰り返すことができます。

クロノグラフ秒針、分カウンターおよび時カウンターの針の初期化

電池の交換後あるいは、誤った操作もしくは強い衝撃や磁気を受けると、クロノグラフ秒針および/または分カウンターや時（アワー）カウンターの針が元の位置に戻らないことがあります。そのような場合、以下のように補正してください：

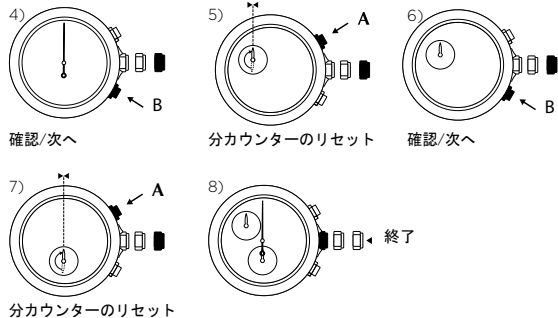
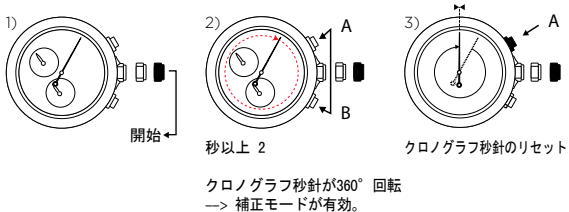

注意：腕時計の防水性を保つために、使用時は、必ずリューズを押し込んだ位置にしてください。決して、水中で押しボタン A/B やリューズを操作しないでください。



電池のタイプ：
395 - SR57

CHRONO & DATE

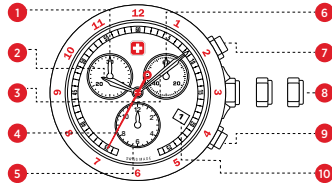

1. 분단위 계산기
2. 시침
3. 분침
4. 크로노 바늘(1/1 초)
5. 시단위 계산기
6. 작은 초침
7. 누름 버튼 A: 시작/정지
8. 크라운
9. 누름 버튼 B: 분할/리셋
10. 날짜 창

시간 설정

설정

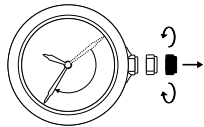

재설정

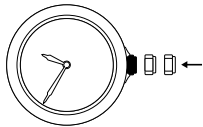

날짜 설정

설정

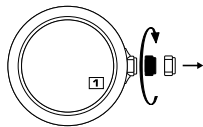

재설정

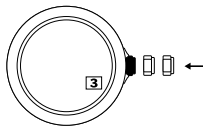

오후 9시에서 오후 12시 사이에 날짜를 변경할 때는 날짜를 다음 날로 설정해 주어야 합니다.

누적 시간 측정

시작

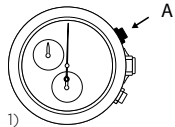

정지

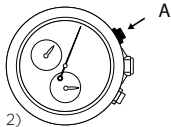

재설정

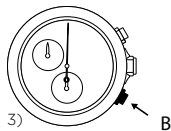

1단계와 2단계를 연이어 여러 번 반복할 수 있습니다.

분할 시간 측정

시작

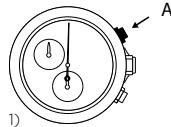

분할

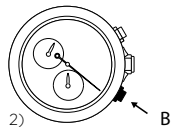

재설정

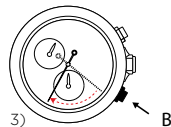

정지

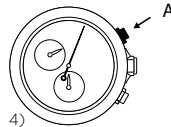

재설정

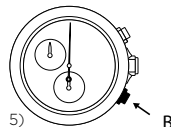

2단계와 3단계를 연이어 여러 번 반복할 수 있습니다.

크로노 및 카운터 핸즈 재초기화

배터리 교체, 잘못된 작동, 강한 충격 또는 강한 자기장에 노출된 경우, 크로노 핸즈 및/또는 카운터 핸즈가 원래 위치(0)로 돌아가지 않을 수 있습니다.

크로노 및 카운터 핸즈를 조정하려면 다음과 같이 진행하십시오:

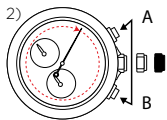
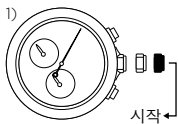

최소 2초

크로노 바늘이 360° 회전합니다.
→ 수정 모드가 활성화되어 있습니다

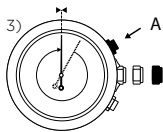

크로노 바늘 재설정

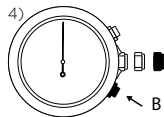

확인/다음

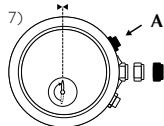

시단위 계산기 재설정

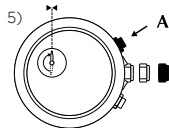

분단위 계산기 재설정

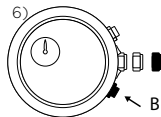

확인/다음

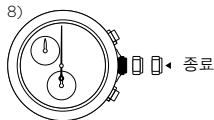

종료

주의 사항: 시계의 방수 기능이 제대로 기능하도록 항상 크라운을 밀어넣은 상태를 유지하십시오.



:배터리 종류
395 - SR57

хроно / дата

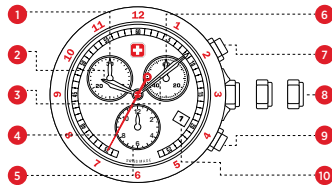

1. Счетчик минут
2. Часовая стрелка
3. Минутная стрелка
4. Стрелка хронографа(1/1 с)
5. Счетчик часов
6. Малая секундная стрелка
7. Кнопка А: пуск/стоп
8. Заводная головка
9. Кнопка В: разделение/сброс
10. Указатель даты

Установка времени

УСТАНОВКА

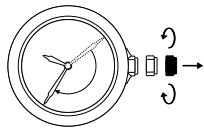

СБРОС

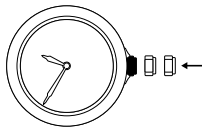

Установка даты

УСТАНОВКА

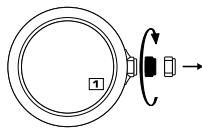

СБРОС

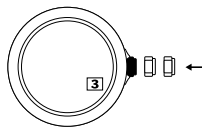

Во время фазы изменения даты в период между 21:00 и 24:00 в качестве даты требуется установить дату следующего дня.

Измерение суммарного времени

ПУСК

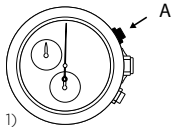

СТОП

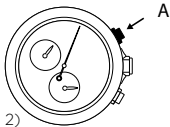

СБРОС

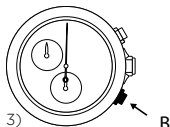

Шаг 1 и 2 можно повторять несколько раз подряд

Измерение отдельных отрезков времени

ПУСК

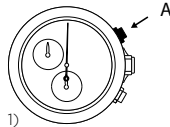

РАЗДЕЛЕНИЕ

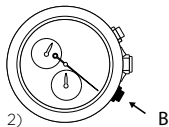

ПОВТОРНЫЙ ЗАПУСК

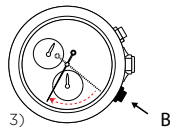

СТОП

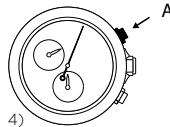

СБРОС

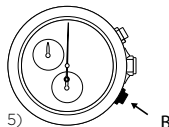

Шаг 2 и 3 можно повторять несколько раз подряд

Повторная инициализация стрелок хронографа и счетчика

После замены батареи, неправильного включения, сильного сотрясения или воздействия сильного электромагнитного поля стрелка хронографа и (или) стрелки счетчика могут не вернуться в исходное положение.

Выполните следующие действия для калибровки этих стрелок:

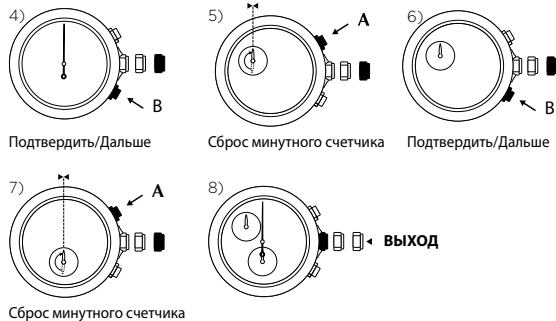

Предупреждение: Для обеспечения водонепроницаемости часов необходимо убедиться в том, что заводная головка всегда находится в исходном положении. Категорически запрещается использовать кнопки A/B и заводную головку при нахождении часов под водой.



Тип батареи:
395 - SR57

ليجستال / ونورك

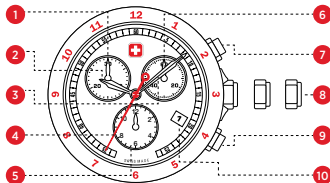

1. عداد الدقائق
2. عقرب الساعات
3. عقرب الدقائق
4. عقرب الكرونو (1/1 ثانية)
5. عداد الساعات
6. عقرب الثواني الصغير
7. زر الضغط A: تشغيل/إيقاف
8. التاج
9. زر الضغط B: فصل/إعادة ضبط
10. نافذة التاريخ

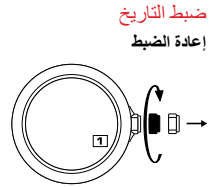
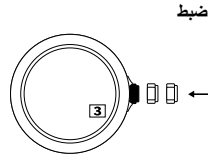
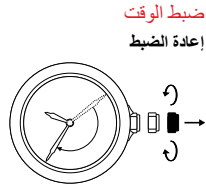
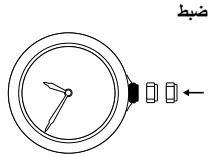

خلال مرحلة تغيير التاريخ بين الساعة ٩ مساءً والساعة ١٢ ظهرًا؛ يجب ضبط التاريخ على تاريخ اليوم التالي.

لصفا لتاقوا سايق

تشغيل

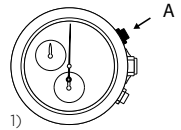

فصل

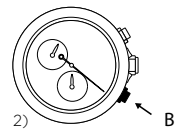

إعادة تشغيل

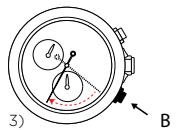

يملكارتلا تقولا سايق

تشغيل

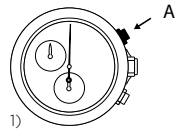

إيقاف

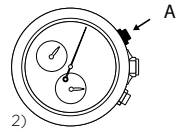

إعادة الضبط

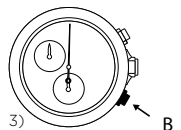

إيقاف

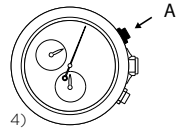

إعادة ضبط

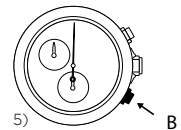

يمكن تكرار الخطوتين 2 و 3 عدة مرات تباعاً

يمكن تكرار الخطوتين 1 و 2 عدة مرات تباعاً

إعادة تهيئة الكرونو وعداد الدقائق وعداد الساعات

بعد تغيير البطارية أو إعادة التشغيل غير الصحيح أو الاصطدام العنيف أو التعرض لمجال مغناطيسي قوي، قد لا يعود الكرونو وعقرب عداد الدقائق و/أو الساعات إلى وضعه الأصلي. لمعايرة العقارب، اضبط على النحو التالي:

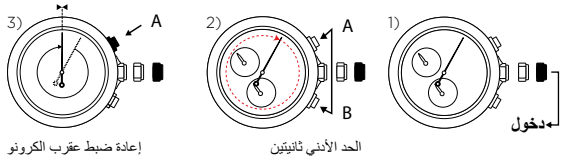

عقرب الكرونو يدور ٣٦٠ درجة
← يتم تشغيل وضع التصحيح.

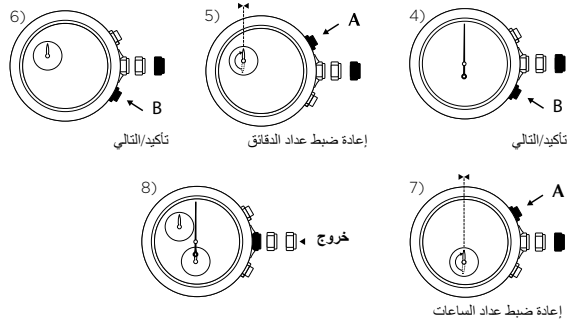

تنبيه: تأكد دائماً من أن التاج في وضع الضغط للداخل لضمان مقاومة الساعة للماء.
لا يجب تشغيل زري الضغط A\B والتاج تحت الماء.

نوع البطارية:
٣٩٥ - ١,٥ فولت



www.swissmilitary-hanowa.com



SMH-IM-5030D